

MM W2700

Vertical offset, direct or remote mount marine transmission.

Maximum rated input: 670kW (897hp)

Available for Medium and Continuous Duty applications.

Description

- Robust design also withstands continuous duty in workboat applications .
- Fully works tested, reliable and simple to install .
- Design, manufacture and quality control standards comply with ISO 9001 .
- Reverse reduction marine transmission with hydraulically actuated multi-disc clutches .
- Compatible with all types of engines and propulsion systems .

Features

- Case hardened and precisely ground gear teeth for long life and smooth running .
- Output shaft thrust bearing designed to take maximum propeller thrust astern and ahead .
- Smooth and reliable hydraulic shifting with control lever for attachment of push-pull cable or other operating system .
- Suitable for twin engine installations (same ratio and torque capacity in ahead or astern mode) .
- Emergency "get home" capability .
- Robust cast iron casing .
- Free standing .
- Oil cooler complete with fittings and flexible hoses .
- Separated brackets .

Options

- Engine-matched torsional coupling .
- Propeller shaft flange and coupling bolt sets .
- Mounting brackets .
- SAE 1 or SAE 0 bell housings .
- Trolling valve for slow-speed drive .
- Electric clutch control (24 VDC) .

MM W2700

Ratings

Medium Duty

RATIOS	MAX. TORQUE		POWER/RPM		SAMPLE POWER CAPACITIES						MAX. RPM
	Nm	ftlb	kW	hp	kW	hp	kW	hp	kW	hp	
					1800 rpm		1900 rpm		2100 rpm		
3.500, 4.000, 4.840, 5.036, 5.500, 6.042	3047	2247	0.3191	0.4279	574	770	606	813	670	899	2200

Continuous Duty

RATIOS	MAX. TORQUE		POWER/RPM		SAMPLE POWER CAPACITIES						MAX. RPM
	Nm	ftlb	kW	hp	kW	hp	kW	hp	kW	hp	
					1200 rpm		1600 rpm		1800 rpm		
3.500, 4.000, 4.840, 5.036, 5.500, 6.042	2691	1985	0.2818	0.3779	338	453	451	605	507	680	2200

MM W2700

Dimensions

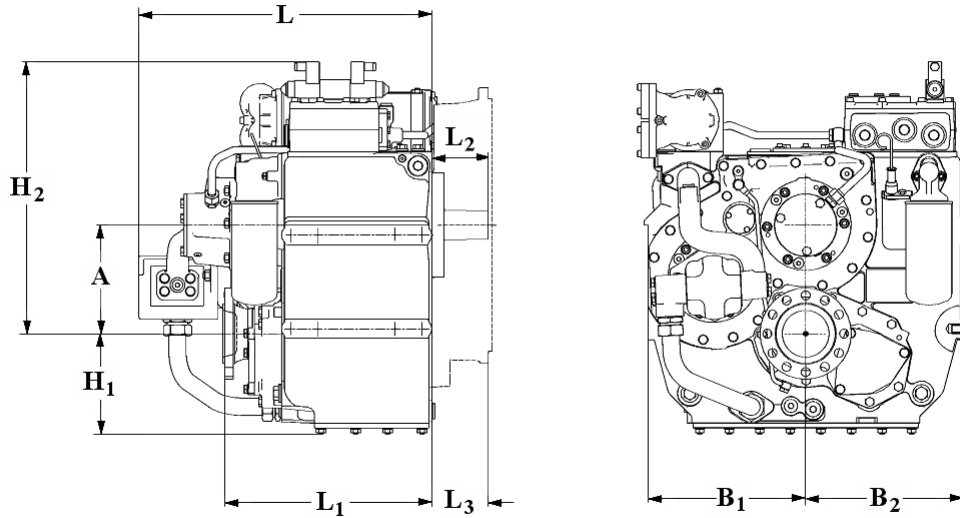

mm (inches)									
A	B ₁	B ₂	H ₁	H ₂	L	L ₁	L ₂	L ₃	Bell Hsg.
390 (15.4)	400 (15.8)	400 (15.8)	365 (14.4)	702 (27.6)	589 (23.2)	435 (17.1)	115 (4.53)	115 (4.52)	0
Weight kg (lb)					Oil Capacity Litre (US qt)				
760 (1672)					30.0 (31.8)				

SAE Bell Housing Dimensions

SAE No.	A		B		C		Bolt Holes		
	mm	in	mm	in	mm	in	No.	Diameter	
								mm	in
0	647.7	25.5	679.45	26.75	711.2	28.0	16	13.49	17/32
1	511.18	20.125	530.23	20.875	552.45	21.75	12	11.91	15/32

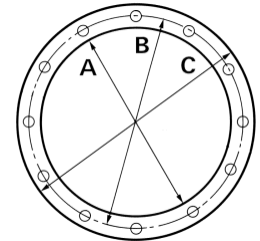

Output Coupling Dimensions

A		B		C		D		Bolt Holes		
mm	in	mm	in	mm	in	mm	in	No.	Diameter (E)	
									mm	in
285	11.2	245	9.65	175	6.89	22.0	0.87	12	20.2	0.80

